

Micro-Ray

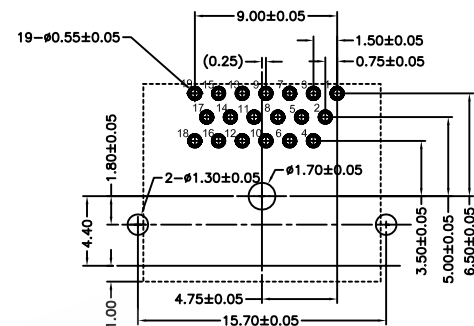

RECOMMENDED PCB LAYOUT (t=1.60±0.15)
COMPONENT SIDE

NOTE:
 1. MECHANICAL CHARACTERISTICS
 INSERTION FORCE: 44.1N MAX
 WITHDRAWAL FORCE: 9.8N MIN, 39.2N MAX
 MATING CYCLE: 10000 CYCLES
 CONTACT PULL OUT FORCE: 1.96N/PIN MIN
 2. ELECTRICAL CHARACTERISTICS
 RATING CURRENT: 0.5A
 RATING VOLTAGE: 40V
 CONTACT RESISTANCE: 10 MILLOHMS OHMS MAX
 (EXCLUDING CONDUCTOR RESISTANCE)
 INSULATION RESISTANCE:
 a. UNMATED: 100M OHMS MIN AT 500 VDC
 b. MATED: 10M OHMS MIN AT 150 VDC
 DIELECTRIC WITHSTANDING VOLTAGE: 300V AC/1MINUTE
 OPERATING TEMPERATURE: -20°C--+85°C
 STORAGE TEMPERATURE: -20°C--+65°C

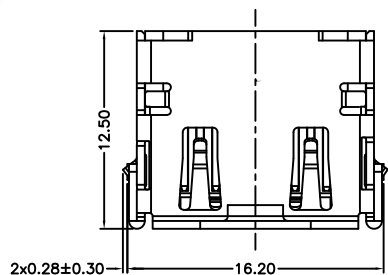
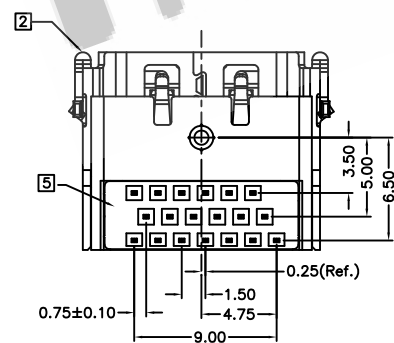
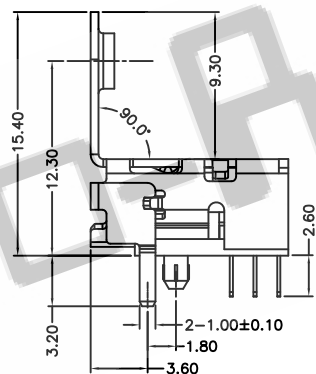
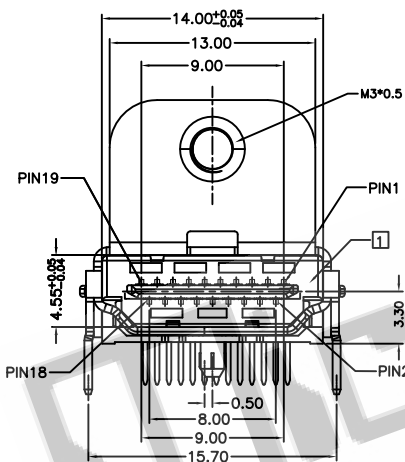
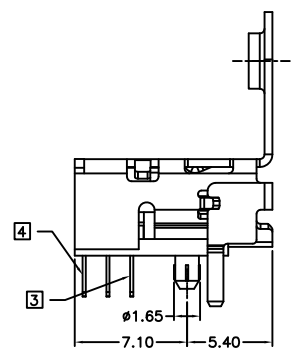

PART NO. INFORMATION

MR-A1119E1-X-XX-T
 FORM A: ASS'y
 SERIES 11: HDMI-A/F
 NUMBER OF POS. 19
 FOLLOW NO. E1
 D: SOLDER TAIL AU PLATED
 F: SOLDER TAIL MATTE TIN PLATED
 PACKING TYPE T: TRAY
 CONTACT AREA PLATING
 01: Au 1u"
 03: Au 3u"
 05: Au 5u"
 10: Au 10u"
 15: Au 15u"
 30: Au 30u"

04	COVER	LCP, (BLACK) UL94V-0	Black	1
03	Contact	C5210R-H	Gold plating on contact area see part no. 80u" min Sn plated on solder tails. 50u" min nickel under plated over all	19
02	Shell	C2680	Solderable Ni 50u" Min.	1
01	Housing	LCP	Black	1
NO.	Name	Material	Plated/Color	Note

X. ±	HDMI-A/F/19PIN/With Flange /Dip 90° /3 ROWS CONNECTOR	Micro-Ray
.X ± 0.25		
.XX ± 0.20		
.XXX ±		
X° ± 2.5°	DR: Cola Lee	PART NO: MR-A1119E1-X-XX-T
.X° ± 2°	UNITS: mm	SCALE: NONE
	DWG NO: C-A1119E1-A(D,F)-XX-X	SHEET: 10F1
		REV: E

E	TE2017-XXXX	更新产品视图错误	2017.08.31
D	TE2014-0100	变更铁壳结构	2013.12.10
C	TE2009-727	增加锡脚电镀雾锡选项	2009.12.18
B	TE2009-605	更换图框, 导入新料号, 增加无LOGO选项	2009.11.03
A	TE2008-119	DRAWING RELEASE	2008.10.14
REV	ECN NO	DESCRIPTION	DATE